



# QuickSAT<sup>®</sup>

## QS45 USER MANUAL



# About QuickSAT

Congratulations on your new purchase and welcome to the world of QuickSAT Satellite TV, QuickSAT is the simplest touring satellite system to set up and operate.

This guide will take you through the simple process required to get you watching all of your favourite channels as soon as possible.

The QuickSAT Satellite Kit includes everything you need to watch Digital Satellite TV on the move. Each kit includes the QuickSAT flat dish, sturdy lightweight tripod with ground fixings, a QuickSAT elevation and alignment kit, all the necessary leads and connections and optionally a pre-tuned dual voltage 240 volt AC/12 volt DC satellite receiver.

The product can easily be transported and stowed away in the supplied carry bag and is quite possibly the lightest most portable product currently available on the market.

Please note that it is important to retain your receipt or proof of purchase so that we are able to assist and deal with any enquiries you may have.

QuickSAT is a product and brand name of Falcon Technical Ltd using our patented smart satellite finding technology

For more information on QuickSAT and our products please visit our website:  
[www.quicksatuk.com](http://www.quicksatuk.com)

## Get in touch

QuickSAT c/o Falcon Technical Limited  
Hill Farm, Northwich Road,  
Dutton, Cheshire, WA4 4LE, UK

UK Enquiries: 01928 759 239  
International: +44 (0) 1928 759 239  
Email: [contact@quicksatuk.com](mailto:contact@quicksatuk.com)

## Package Contents:

*Thanks for purchasing QuickSAT, the easy to use touring satellite system.  
With your purchase you will find the following contents:*



A

dish



B

Tripod &amp; pegs



C

Satellite cable



D

Elevation indicator



E

Micro speaker



F

Mini receiver



G

RCA cable



H

Remote eye



I

Remote control



J

Sat mat &amp; compass



K

Quicksat carry case

Note: Items F,G,H,I are only included with the optional mini receiver.

## Getting Started: DISH SETUP

- 1) Loosen the fixing clamp on the tripod stand and push the legs downwards.
- 2) Extend the feet of the tripod stand as far as they will go for maximum stability
- 3) Ideally the tripod should be placed on reasonably level ground so that the tripod is vertical, use the ground anchor pegs to secure the tripod.

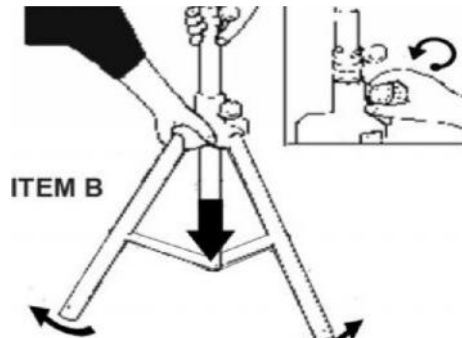

Do not connect any leads until your satellite dish is firmly on the tripod

- 4) Using the Sat Mat and compass (Item J) align one of the tripod legs so that it is in the direction of the arrow on the mat (FIG 2) and follow the instructions on the Sat Mat.

- 5) Position and secure the dish to the tripod using the thumbscrew.

- 6) Once the dish is secured on the tripod it should look like the image (FIG 3) Do not overtighten the thumbscrew at this point as rotation will be required for the final step in tuning



FIG 2



Sat Mat



FIG 3

## Getting Started: DISH CONNECTIONS



7) Connect the F-type connector (screw in connector) on the 10 metre dual cable (Item C) to either of the matching screw sockets on the LNB and the 3.5mm jack plug to the input socket on the arm as indicated above.

8) Attach the magnetic base of the elevation meter (Item D) to the black wedge on the arm.

9) Insert the micro speaker (Item E) in to the output socket located on the side of the arm

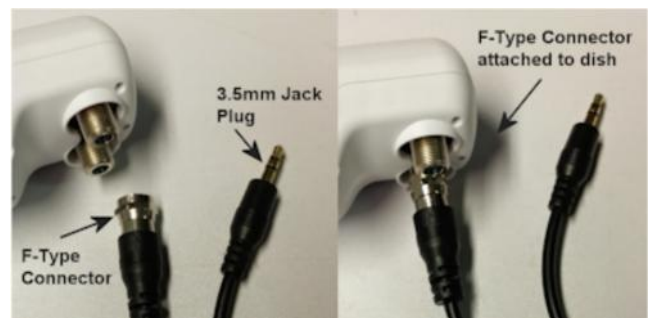

**Please** ensure the micro speaker has batteries inserted and the switch is set **to ON**

Once you have assembled your **QuickSAT dish** it should look like the image below:



## Getting Started:

### CONNECTING RECEIVER

NOTE: These instructions show the optional QuickSAT mini receiver (Item F) but the procedure will be very similar for other FREESAT and SKY set top receivers.

This section takes you through connecting the receiver.

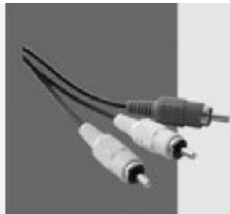

Connect the receiver to the TV, images 1 & 2 below show the optional mini receiver connected using the RCA lead and SCART adapter



Image 1



Image 2



Connect the F-type connector on the dual cable (Item C) from the satellite dish to the threaded **LNB Input** socket on the receiver (or LNB input on a TV with integrated receiver)



Locate the headphone socket on your TV and plug in the 3.5mm jack plug from the dual cable (Item C) into it



Connect the receiver to the power supply and position close to the TV.



Please ensure all equipment is switched off before connecting/disconnecting any cables



If using the optional mini receiver plug the remote eye (Item H) into the mini receiver (Item F) and position the eye on the front of the TV using the supplied adhesive pad

## Getting Started: POWER UP & TUNING

- 1) Switch on your TV and satellite receiver
- 2) Using your TV remote control select the SCART or AV input to view the receiver menu or select the satellite input if using a TV with integrated receiver
- 3) You should now see a 'no signal' or 'bad signal' message
- 4) Using the receivers remote (or TV remote if using a TV with integrated receiver) select BBC 1 (just press the 1 button if using the optional mini receiver, for other receivers/TVs refer to its own user manual for instructions). The screen will return to the 'No signal' message after a few seconds. You are now ready for the next part of the tuning process.



Note: The optional mini receiver has been pre-tuned to Astra 28 for UK TV, for other satellites and channels please use the supplied mini receiver user guide



Note: If you are using your own receiver or a TV with integrated receiver you should make sure that it has a channel list before use, if it does not then you should follow the procedure to update the channels while it is connected to a pre-aligned dish.

- 5) If using the optional mini receiver use the remote (Item 1) to increase the volume to full
- 6) Using the TV remote increase the volume to full

You are now ready to start the alignment of your dish

- 7) With the dish face starting at vertical slowly tilt the top of dish back until the correct Elevation for your camping location reads on the Elevation meter as demonstrated (Fig 1 )

You can get the correct elevation for you location from the QuickSAT elevation chart or by using [www.dishpointer.com](http://www.dishpointer.com) or an app on your smartphone such as Sat Finder.

Fig 1





## Getting Started: ALMOST FINISHED!

- 8) Tighten the wingnut to secure the dish at the correct elevation level
- 9) With the dish pointing in the same direction as the arrow on the the Sat Mat as shown on the right, slightly tighten the thumbscrew on the tripod (so the dish can still be rotated)
- 10) Slowly rotate the dish from right to left, as you pass over the arrow on the Sat Mat, as you pass over the correct position you will hear sound from the micro speaker, continue to slowly position the dish until the sound is clear
- 11) Fully tighten the thumbscrew
- 12) Your TV should now be displaying BBC 1
- 13) Switch off and remove the micro speaker and elevation meter and store safely
- 14) Turn the volume on your TV down and remove the jack from the headphone socket on your TV and the audio will resume normal operation
- 15) Congratulations! the dish is now perfectly aligned!



Please ensure all equipment is switched off before connecting/disconnecting any cables



## Notes for use with SKY boxes



**The procedure when using a SKY receiver is broadly the same with a few things to note:**

1. Connect the F-type connector on the dual cable (Item C) from the satellite dish to the LNB input on your SKY box.
2. You must ensure your SKY box has a channel list before use, if the box has not been used for a while it may have lost its channel list. We recommend checking this before leaving home. If you do not have a channel list then you should connect the box to an already aligned dish and run a channel search.
3. Due to encryption used by sky it is better to move the dish in staggered movements (at step 10), pausing for a few seconds every degree to allow time for the signal to decode.



**For SKY receivers make sure your receiver has a channel list before use**

## Notes for use with TVs with integrated receiver (including Cello Traveller and Avtex DRS)

The procedure for a TV with an integrated receiver is exactly the same as for a separate receiver, just connect the F-type connector to your TV's LNB/Antenna input and select the correct input on your TV, this may be called Satellite, DVB-S, STV or ATV. Refer to your TV instruction manual for more details.



## End of Life Disposal

### A. Information on Disposal for Users (private households)



#### 1. In the European Union

Attention if you want to dispose of this equipment, please do not use the ordinary dustbin! Used electrical equipment must be treated separately and in accordance with legislation that requires proper treatment, recovery and recycling of used electrical and electronic equipment. Following the implementation by member states, private households within the EU states may return their used electrical and electronic equipment to designated collection facilities free of charge. In some countries your local retailer may also take back your old product free of charge if you purchase a similar new one. Please contact your local authority for further details. If your used electrical or electronic equipment has batteries or accumulators please dispose of these separately beforehand according to local requirements. By disposing of this product correctly you will help ensure that the waste undergoes the necessary treatment, recovery and recycling and thus prevent potential negative effects on the environment and human health which could otherwise arise due to inappropriate waste handling.

#### 2. In other Countries outside the EU

If you wish to discard this product please contact your local authorities and ask for the correct method of disposal. For Switzerland Used electrical or electronic equipment can be returned free of charge to the Dealer, even if you don't purchase a new product. Further collection facilities are listed on the homepage of [www.swico.ch](http://www.swico.ch)

### B. Information on Disposal for Business Users

1. In the European Union If the product is for business users and you want to discard it: Please contact your QuickSAT dealer who will inform you about the take-back of the product. You might be charged for the costs arising from take — back and recycling. Small products (and small amounts) might be taken back by your local collection facilities.

2. In other Countries outside the EU If you wish to discard this product please contact your local authorities and ask for the correct method of disposal.



The batteries supplied with this product contains traces of Lead.

For EU: The crossed out wheeled bin implies that used batteries should not be put to the general household waste! There is a separate collection system for used batteries to allow proper treatment and recycling in accordance with legislation. Please contact your local authority for details on the collection and recycling schemes.

For other non —EU countries. Please contact your local authority for correct method of disposal of the used battery.

## WARRANTY DISCLAIMER

QuickSAT is a trademark of Falcon Technical Ltd. All technology and techniques used to build and deliver our products are intellectual property of the above named company or its associated partners. It is against copyright laws to attempt to extract, reverse engineer, copy or manipulate the patent registered technology included with our products and any party who may breach these conditions set herewith will be subjected to legal action to the full extent of the law in his or hers jurisdiction.

All QuickSAT products are covered by a 1 year warranty against any hardware defects (ONLY). Any damages or accidental breakages to have been caused by user during installation or at any other time will not be covered under the terms of this agreement.

The contents of this publication are believed to be correct at the time of going to press however any information, Details, products or services may be supplemented, modified or withdrawn without notice.



## Finding the elevation for your location

For UK Freesat you want to select the 28.2 E Astra option on your receiver.  
Find the town or city nearest to your location and adjust the elevation angle of the dish.

### Methods for finding the elevation.

#### 1. On your phone or tablet

If you have an iPhone or Android smartphone you can use one of the apps such as "Satfinder" to use the phones GPS receiver to pinpoint your location and tell you the correct elevation.

#### 2. On a computer

On a computer visit [www.dishpointer.com](http://www.dishpointer.com) and enter your location

#### 3. Use the elevation map below



#### 4. Use the following tables

##### United Kingdom

Town/City	Elevation
ABERDEEN	19.73
BIRMINGHAM	23.86
BRISTOL	24.45
CARDIFF	24.15
CHILWORTH	25.35
EDINBURGH	20.41
GLASGOW	20.11
GOONHILLY	24.53
INVERNESS	18.73
LERWICK	17.4

##### United Kingdom

Town/City	Elevation
LIVERPOOL	22.64
LONDON	25.37
MADLEY	23.86
MANCHESTER	22.84
NEWCASTLE	21.77
PLYMOUTH	24.72
STORNOWAY	17.41
TEDDINGTON	25.77
WINCHESTER	25.3

##### Ireland

BANTRY	21.25
BELFAST	20.5
CORK	21.59
DUBLIN	21.38
LONDONDERRY	19.74

##### Austria

GRAZ	34.45
INNSBRUCK	33.21
SALZBURG	33.16
VIENNA	33.46

##### Belgium

BRUSSELS	27.56
----------	-------

##### Belarus

BREST	30.25
GOMEL	30
GRODNO	28.56
MINSK	28.45
MOGILEV	28.43
VITEBSK	27.03

**Bulgaria**

BURGAS	40.93
PLOVDIV	41.21
RUSE	39.41
SOFIA	40.47
STARA ZAGORA	40.96
VARNA	40.16

**Czech Republic**

BRNO	32.46
PRAHA	31.09

**Denmark**

COPENHAGEN	24.97
------------	-------

**Finland**

HELSINKI	21.67
JOENSUU	19.17
KEMI	15.83
KUOPIO	18.87
OULU	16.64
TAMPERE	20.25
TURKU	21.26
VAASA	18.46

**France**

AJACCIO	37.67
BASTIA	37.17
BIARRITZ	31.66
BORDEAUX	30.95
BREST (F)	26.12
DIJON	31.11
LE HAVRE	30.73
LIMOGES	30.93
LYON	32.53
MARSEILLE	35.06
NICE	35.4
PERPIGNAN	34.47
RAMBOUILLET	28.74
RENNES	27.69
ROUEN	27.65
STRASBOURG	30.89

**Germany**

BADEN-BADEN	30.83
BERLIN	28.38
BONN	28.55
COLOGNE	28.32
DRESDEN	29.97
ERFURT	29.41
FRANKFORT	29.64
GERA	29.75
HAMBURG	26.59

**Germany**

LANGENBERG	27.97
LEIPZIG	29.41
MAINZ	29.62
MUNICH	32.41
ROSTOCK	26.51
STUTTGART	31.13

**Greece**

ATHENS	45.75
KERKYRA	43.36
SALONIKA	42.71
THESSALONIKI	42.71

**Hungary**

BUDAPEST	34.7
DEBRECEN	35.01
GYOR	34.23
MISKOLC	34.29
SZEGED	36.2
TALIANBOROGD	35.06

**Iceland**

REYKJAVIK	7.62
-----------	------

**Italy**

BARI	41.05
BOLOGNA	36
BRINDISI	41.86
CAGLIARI	40.46
CATANIA	44.39
FIRENZE	36.73
FUCINO	39.23
GENOVA	35.33
MILAN	34.39
NAPLES	40.65

**Italy**

PALERMO	43.16
ROME	39.01
SASSARI	38.76
TORINO	34.2
UDINE	34.97
VENEZIA	35.37

**Latvia**

RIGA	25.14
------	-------

**Lithuania**

VILNIUS	27.58
KAUNAS	27.26

**Luxembourg**

DUDELANGE	29.46
BETZDORF	29.32
LUXEMBOURG	29.3

**Netherlands**

AMSTERDAM	26.29
EINDHOVEN	27.37

**Norway**

BERGEN	18.82
BODO	13.56
OSLO	20.38
TROMSO	11.61
TRONDHEIM	16.9

**Poland**

BIALYSTOK	29.09
GDANSK	27.3
KIELCE	31.32
KRAKOW	32.09
LUBLIN	30.99
OLSZTYN	28.18
RADOM	30.76
WARSAW	29.86
WROCLAW	30.54

**Portugal**

FARO	32.86
FUNCHAL	28.85
LAGOS	32.3
LISBON	30.87

**Romania**

ARAD	36.44
BACAU	36.42
BRAILA	37.87
BRASOV	37.39
BUCHAREST	38.79
CONSTANTA	39.07
GALATI	37.67
ORADEA	35.54
PLOIESTI	38.18
SIBIU	37.13
TIMISOARA	36.89
BRATISLAVA	33.66

**Spain**

ALICANTE	36.52
BARCELONA	35.33
BILBAO	31.11
CARTAGENA	36.8
FUERTEVENTURA	33.41

**Spain**

GIBRALTAR	35.21
GRANADA	35.54
LA PALMA	29.9
LANZAROTE	33.49
LAS PALMAS	32.39
MADRID	32.96
MALAGA	35.41
PALMA	37.11
SAN SEBASTIAN	31.57
SANTA CRUZ	31.4
SANTIAGO	28.32
SEVILLA	33.89
VALENCIA	35.58
VALLADOLID	31.45

**Sweden**

BORLANGE	20.66
GOTEBORG	22.86
KIRUNA	13.47
LULEA	15.89
MALMO	25.17
ORNSKOLDSVIK	18.04
STOCKHOLM	22.06
SUNDSVALL	18.83
UMEA	17.7
AGESTA	22.21

**Switzerland**

BASEL	31.84
GENEVA	32.58
LUGANO	33.77
MONTREUX	32.62
ZURICH	32.27

**Turkey**

BURSA	43.51
ISTANBUL	42.53
IZMIT	42.66

**Ukraine**

CHERNOBYL	31.12
KHARKOV	32.17
KHERSON	36.2

**Yugoslavia**

BEOGRAD	37.81
DUBROVNIK	39.71
SARAJEVO	38.47
SPLIT	38.45

Please note that this list is provided as a guide to elevations and does not guarantee you can receive any or all channels at all these locations.