



# 4.3" Digital Wireless Camera Kit User Guide



**Ask Grandad**  
*It's all a learning experience*

**Ask Grandad on 01928 759239**

**or visit [www.falcontechonology.co.uk/askgrandad](http://www.falcontechonology.co.uk/askgrandad)**





Thank you for purchasing our digital wireless camera system.

These instructions tell you how to operate and get the best from your new camera.

Please read the manual carefully before using. We hope you enjoy this system.

**CAUTION:** Do not install the monitor where it may obstruct the drivers view or obstruct an air bag device.

### **Specifications**

Monitor operating voltage: 9V-24V

4.3" LCD Monitor

Wireless operating distance: Up to 20 metres in open space

Waterproof to IP68

Viewing angle: 120 degrees

Usable illumination: 0 Lux (IR on)

Operating temperature: -20C ~ +70C

## **Attaching the camera to your motorhome or caravan**

The base of the camera is magnetic, if you have a suitable steel surface you can attach the camera directly to that.

If you don't have a suitable steel surface you can attach the included white steel plate to your vehicle using the included adhesive and then attach the camera to that.

Please see the instructions on the next two pages to mount the plate.

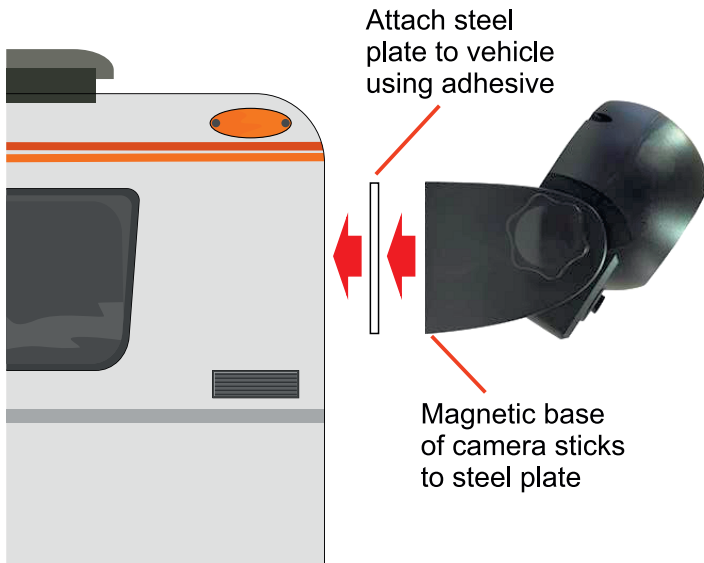

## **Attaching the metal plate**

Find a suitable location to mount the camera and clean the area thoroughly ensuring it is dust and grease free.



Place the metal plate in position and draw around it with a pencil or washable ink pen.



Mark out the area with insulation tape.



## Attaching the metal plate

Spread glue on the back of the metal plate covering it evenly.



Position the plate in the marked area and apply tape to hold it in position.



Leave it for 24 hours then remove the tape and you can attach the camera.



### **Charging the camera**

To charge your camera pull the orange cover on the rear of the camera to reveal the charging socket and plug the charge lead in,



Connect the other end of the charge lead to the included USB to car cigarette lighter/accessory socket adapter or a USB mobile phone adapter.

The camera should reach a full charge from flat in approximately 4.5 hours.

The LED on the camera is red when the camera is charging and switches off when the camera is fully charged.

After charging be sure to refit the orange rubber cover to the charge socket to prevent water ingress.

## **Pairing the camera and monitor**

The system comes already paired so you should not need to pair them unless replacing the monitor or camera.

### **Pairing:**

1. Turn the camera on by pressing the power button for 2 seconds.
2. Hold the power button on the camera for 6 seconds until the LED flashes Blue, the camera is now in pair mode for 10 seconds.
3. Turn on the monitor by pressing the power button for 3 seconds.
4. Push the pair button on the monitor until PAIR OK is displayed.
5. Turn the monitor off by pressing the power button for 3 seconds and then turn it back on.

The system is now paired.

If you have any questions then please

**Ask Grandad**  
*It's all a learning experience*



[www.falcontechonology.co.uk/askgrandad](http://www.falcontechonology.co.uk/askgrandad)

01928 759239