

7" Wireless Camera System

Technical support:
0906 700 1020
support@falcon-security.com

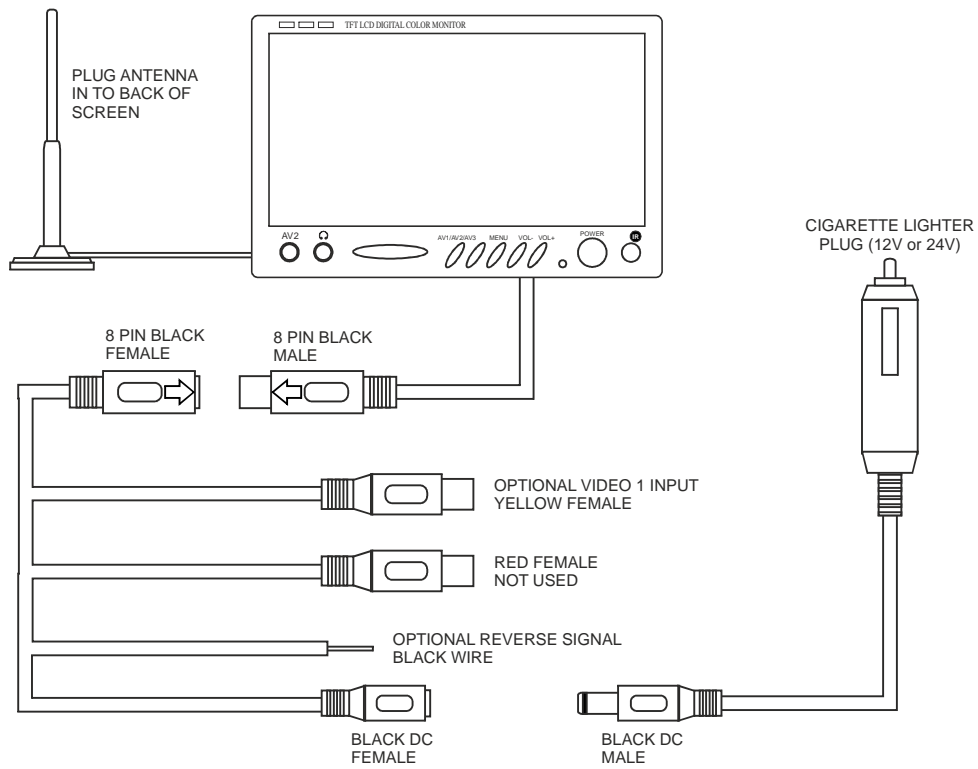

Connection of 7" Wireless LCD Monitor

Plug the wiring loom into the monitor with the 8 pin connectors and connect the cigarette lighter plug to the black DC socket. For wireless operation the cigarette lighter plug just needs plugging in to the vehicle. The monitor can be powered from 12 Volts or 24 Volts.



Operation of 7" Wireless LCD Monitor

Wireless cameras

Up to four wireless cameras can be used with the system, to view the wireless cameras select Video 3 using the on screen menus or the AV button on the remote control.

Once viewing Video 3 you can switch between up to 4 wireless cameras by pressing the AV button on the front of the screen.



↑
Switch between
up to 4 cameras

Optional wired camera

One wired camera can be connected to the yellow Video 1 input.

To view this camera select Video 1 using the on screen menus or the AV button on the remote control.

Optionally the black wire marked BACKWARD can be connected to the +12V wire from the vehicles reversing light circuit to automatically switch the screen on and switch to this input when the vehicle is put into reverse.

Optional front panel input

The front panel socket marked AV2 can be used to connect a portable DVD player, games console, digital camera etc. To view this input select Video 2 using the on screen menus or the AV button on the remote control.



Connection of wireless cameras

If connecting to a 12 Volt vehicle just connect the red wire to +12V and the black wire to ground.

If connecting to a 24 Volt vehicle the 12-24V converter marked "Manostat"

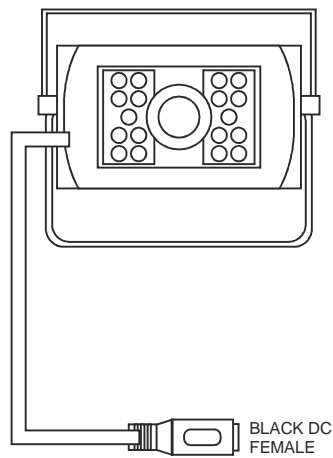

12 Volt Vehicles

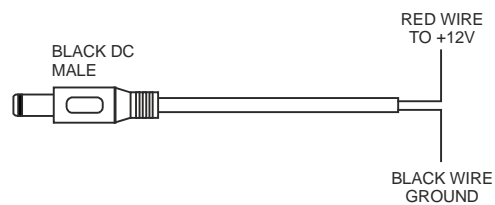

24 Volt Vehicles

