



Smart TV Dongle Owner's Manual





Congratulations on your new purchase and welcome to the world of the Falcon Smart TV Dongle.

This guide will take you through the process required to setup and use your new Smart TV Dongle.

Please note that it is important to retain your receipt or proof of purchase so that we are able to assist and deal with any enquiries you may have.

For more information on our products please visit our website: **www.falcontechnology.co.uk**

Get in touch

Falcon Technical Limited
Hill Farm, Northwich Road
Dutton
Cheshire
WA4 4LE
United Kingdom

UK Enquiries: 01928 759 239
International: +44 (0) 1928 759 239
Email: contact@falcontechnology.co.uk

Connecting the dongle to your TV

Plug one end of the HDMI cable into the smart dongle and the other end into an HDMI input on your TV. Connect the Micro USB cable to the dongle and plug the large USB connector into a USB socket on your TV.

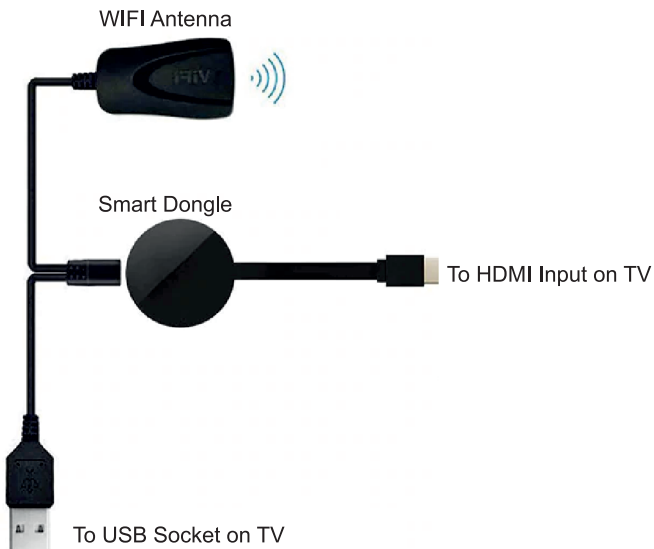

The Smart Dongle is compatible with:

Android 4.4+ Smartphones/Tablets

IOS 7.0+ iPhone/iPad

Windows 8.1/10 Laptop/PC

Use with Android devices

Make sure the dongle is in Miracast mode as shown below. If it is not then press the button on the dongle and wait for it to change to show Mode: Miracast.



Name the dongle
will appear as
on your device

Indicates Miracast
Mode is Active

Now go to the Miracast setting on your phone. Different manufacturers call it different things, it might be Cast, Smart View, WIFI Display, WLAN Display, Wireless Display, Allshare Display, Allshare Cast, Wireless Display etc.

On Samsung devices swipe down from the top of the screen twice and select Smart View.

Select the name of your dongle as displayed on your TV screen which will start with FALCON-

Use with iOS Devices (iPhone/iPad)

Make sure the dongle is in DNLA mode as shown below. If it is not then press the button on the dongle and wait for it to change to show Mode: DLNA/ Airplay.



WiFi name and
password to
connect to

Admin
IP Address

Indicates DLNA
Mode is Active

Connect your iPhone/iPad to the WiFi network name displayed on your TV screen using the password shown.

Open a web browser and enter the Admin IP Address shown on screen (default 192.168.49.1) in the address bar.

You will see the page on shown on the next page.

Use with iOS Devices (iPhone/iPad) Continued

Admin screen:

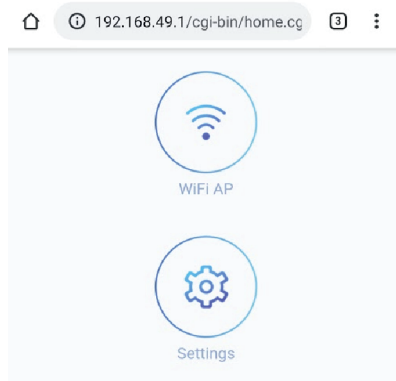

Press on the WIFI-AP icon and on the next page press Scan:

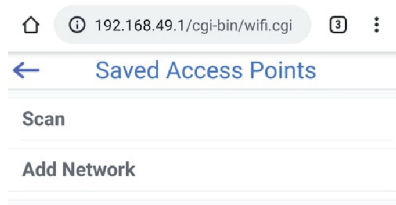

This will show you a list of the nearby WIFI networks, press on yours to continue.

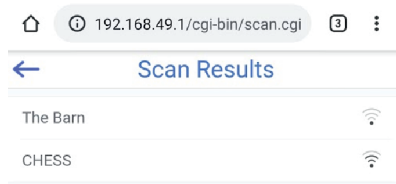

Use with iOS Devices (iPhone/iPad) Continued

On the next screen enter your WIFI password and press Connect

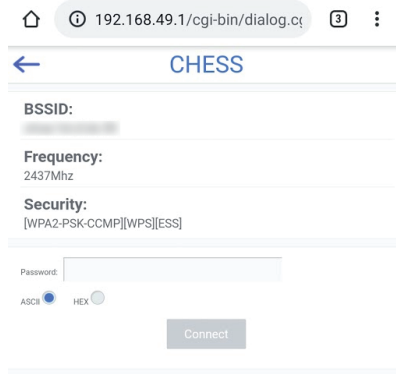

The screenshot shows a web browser interface with the address bar displaying '192.168.49.1/cgi-bin/dialog.ct'. The page title is 'CHESS'. Below the title, there are three sections: 'BSSID:' with a redacted value, 'Frequency:' with the value '2437Mhz', and 'Security:' with the value '[WPA2-PSK-CCMP][WPS][ESS]'. A 'Password:' field is present with a toggle for 'ASCII' (selected) and 'HEX'. A 'Connect' button is at the bottom right.

Back on the TV screen you will see your network name flashing in the bottom right corner, once it has connected it will stop flashing.

Using AirPlay to play video on your TV

For apps that are compatible with AirPlay look for the AirPlay or cast icons:



Press the icon and select the Falcon dongle from the list displayed.

Use with iOS Devices (iPhone/iPad) Continued

For example in the YouTube app:

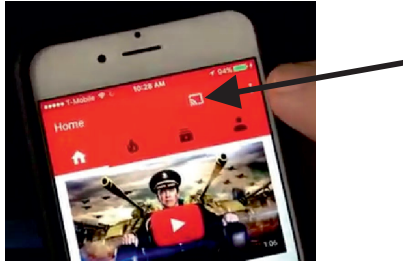

or for BBC iPlayer swipe up from the bottom of the screen, select the AirPlay option and then select the Falcon dongle.

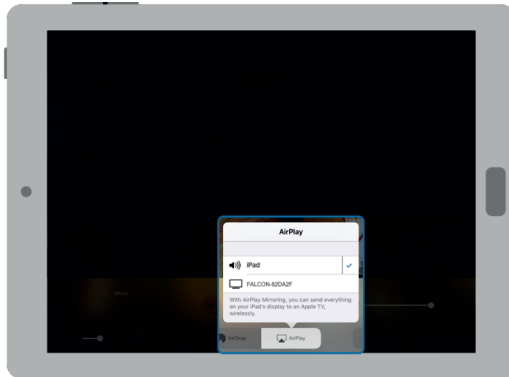

Use with iOS Devices (iPhone/iPad) Continued

iOS Screen Mirroring

For apps that don't support AirPlay you can switch the dongle to screen mirroring mode. In this mode the TV will display what is shown on the iPhone/iPad screen.

Enabling Screen Mirroring

Connect your iPhone/iPad to the WiFi network name displayed on your TV screen using the password shown.

Open a web browser and enter the Admin IP Address shown on screen in the address bar.

On the admin screen press the Settings icon.

Scroll down until you see the option to switch between Airplay and Screen Mirroring.

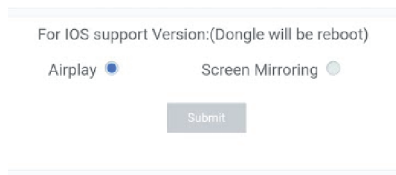

Select screen mirroring and press Submit. Wait for the dongle to reboot and reconnect to your WiFi.

Use with iOS Devices (iPhone/iPad) Continued

On your iPhone/Ipad swipe up to reveal the Control Center and press the Screen Mirroring button then select the Falcon dongle from the list.



To switch back to AirPlay mode simply return to the admin settings and switch the option back to Airplay and wait for the dongle to restart.

Use with Microsoft Windows

Make sure the dongle is in Miracast mode as shown below. If it is not then press the button on the dongle for a couple of seconds and wait for it to change to show Mode: Miracast.



Name the dongle
will appear as
on your device

Indicates Miracast
Mode is Active

On your computer go to Settings, selected devices and then click on "Add Bluetooth or other device".

Select Wireless display or dock.

Select the name of your dongle as displayed on your TV screen which will start with FALCON-

Ask Grandad

It's all a learning experience

Ask Grandad on 01928 759239

or visit www.falcontechnology.co.uk/askgrandad



Another innovative product from Falcon Technical Ltd.
Hill Farm, Northwich Road, Dutton, Cheshire, WA4 4LE